

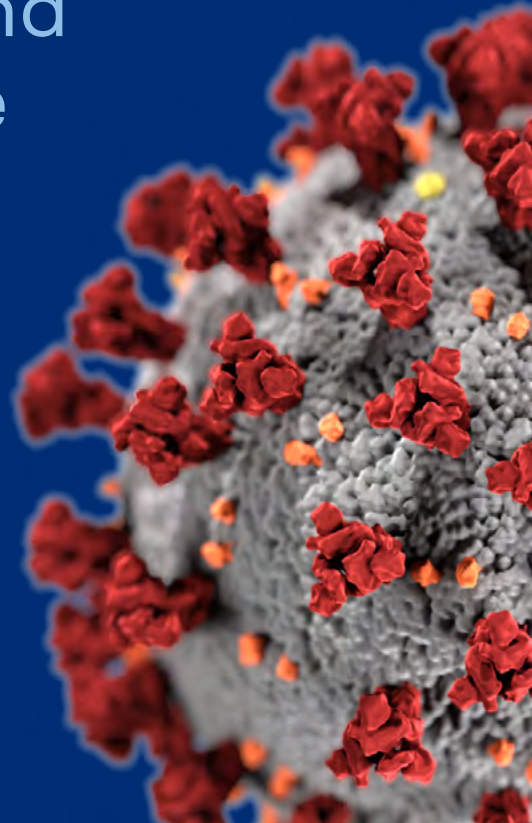

Reopening of the dental practice

How to restart autoclave and thermodisinfector after the Covid-19 closure

The Covid-19 emergency has led to dental practices having to close for several weeks, except for emergency appointments. Now it is possible to carry out ordinary dental procedures as well and it is more important than ever to ensure effective sterilization procedures are in place for patients. How can we get back to doing this with maximum efficiency?



How to restart autoclave and thermodisinfectors after the Covid-19 closure

In addition to compliance with the guidelines issued by authorities with regard to the protection of operators and patients, working environments and methods, the procedures for checking equipment in the sterilization room and getting it running again must not be overlooked. Here are the basic steps to follow to get ready for the reopening of the dental practice:

Autoclave

1. Check electrical and hydraulic connections

Once the main switches are back on, check the electrical connection of the autoclave. Reopen the hydraulic connection to the water treatment systems — such as Aquafilter and Aquaosmo — if installed.

2. Cleaning the sterilization chamber

Cleaning the sterilization chamber eliminates deposits that can compromise the operation of the autoclave.

What to do:

- Thoroughly clean the door gasket and the area of the boiler adjacent to the gasket using a non-abrasive damp cloth (caution: during the cleaning stage only distilled or pure water may be used);
- Remove the tray support and clean the chamber;
- Clean the trays and their support, following the same procedure.



3. Cleaning the water tanks

Proceed to the cleaning of the machine components, in particular the clean and waste water tanks and their metal filters.

What to do:

- After removing the top cover, thoroughly clean the tanks with the sponge supplied, dampened with water, using the sponge side (not the abrasive side), paying particular attention to any deposits of dirt in the corners;
- Detach the filters in the clean water and waste water tanks and rinse with running water, and then insert them back into the tank positioning them correctly;
- Move the level sensors to ensure they work properly.

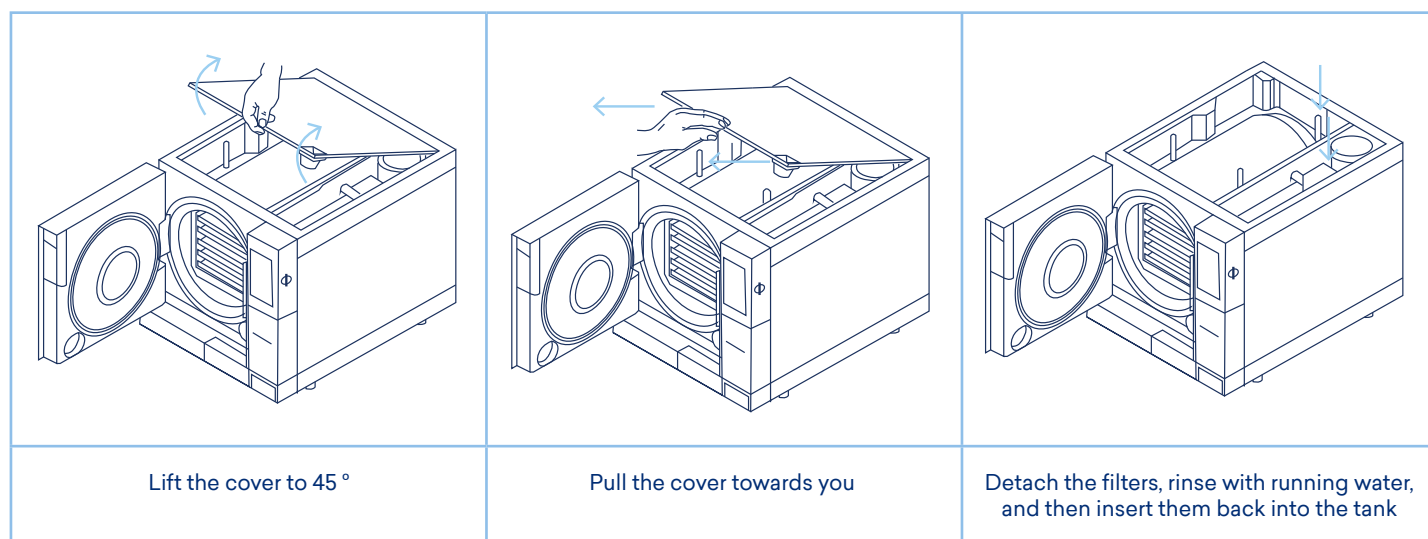

4. Check Print Set

If the autoclave is equipped with a printer, check it has thermal paper/adhesive labels.

5. Create a backup of the SD Card

It is advisable to connect to the E-Memory software (available on the site myeuronda.com by registering the appliance warranty) to create a backup of the SD Card, in order to import the data related to cycles completed by the autoclave and ensure traceability of the cycles over time without any loss of data.

6. Performing and verifying control tests

Perform a **Vacuum Test** with the chamber empty, followed by a **Helix Test** with indicator and verification of the outcome.

With the support of an authorised technician

Three further steps are detailed below, for which the support of an authorised technician is necessary. These are recommended, once the routine servicing of the autoclave is completed, if alarms and/or messages appear on the display for malfunctions and breakdowns.

1. Check the conductivity meter

After filling the tank to the minimum level, verify the correct reading of the conductivity meter, to ascertain the water quality range.

2. Components Test

Via the Components Test program in the Service 2 menu, verify the operation of the main components or the component specified on the display alert.

3. Replacement of door gasket and bacteriological filter

Finally, it is advisable to proceed with the replacement of the door gasket and the bacteriological filter, resetting the relevant counters.



Thermodisinfector

It is not just the autoclave that requires special attention on reopening the practice — also the thermodisinfector — which plays a particularly key role now, as it provides automated pre-washing, washing and thermal disinfection, thus minimising the risk of indirect infection — needs cleaning and inspection, especially filters and washing arms.

1. Inspection and cleaning of the chamber filters

What to do:

- After removing the basket, remove the waste water filter set from the washing chamber. Unscrew the pin and remove the cover from the waste water basket strainer;
- Once the filter is clean, replace it onto the drain of the washing chamber, replace the basket cover and lock it in the correct position by screwing the threaded screw. Replace the waste water basket strainer back into the chamber.

2. Inspection and cleaning of the washing arms

What to do:

- Remove the basket from the washing chamber and unscrew the fixing pin of the two washing arms. Unscrew the caps from the back of the nozzle and remove them;
- Clean and remove any residue from the nozzles of the washing arms;
- Replace the caps in the correct position by checking the seal; then replace the washing arms, locking them in with the appropriate fixing pin.



3. Disinfection of the washing chamber and anti-limescale treatment

To disinfect the washing chamber and the hydraulic circuits, simply perform an empty cycle with the basket in place.

To proceed simultaneously with the anti-limescale treatment, add about 125ml of white vinegar to a load basket or a descaling agent according to the quantities and specifications described in the relevant data sheet

4. External cleaning of the machine

The cleaning of the outer surface of the machinery is also essential: with the aid of a damp cloth, wipe the outside of the machine using alcohol or other neutral disinfectant agents. Avoid the use of abrasive products and any type of solvent and / or diluent.

Further queries:

Contact your authorised technician or write to assistenza.technica@euronda.com

